

Poster Session

- Poster size:
 - maximum size = 86 cm width x 200 cm length
 - recommended size = A0 size = 84.1 cm x 118.9 cm = 33.1 x 46.8 in
- Poster session rooms:
 1. Exhibition room: poster numbers, PA** - PD**:
 2. 2nd foyer of the Grand Hall: poster numbers, PE**:
- Lift-up time
 - Sunday Evening 17:00-19:00
 - Monday Morning 8:00-8:55 or tea break
- Fall-down Time
 - by Friday 14:00

Poster room 1

to JR Krume station

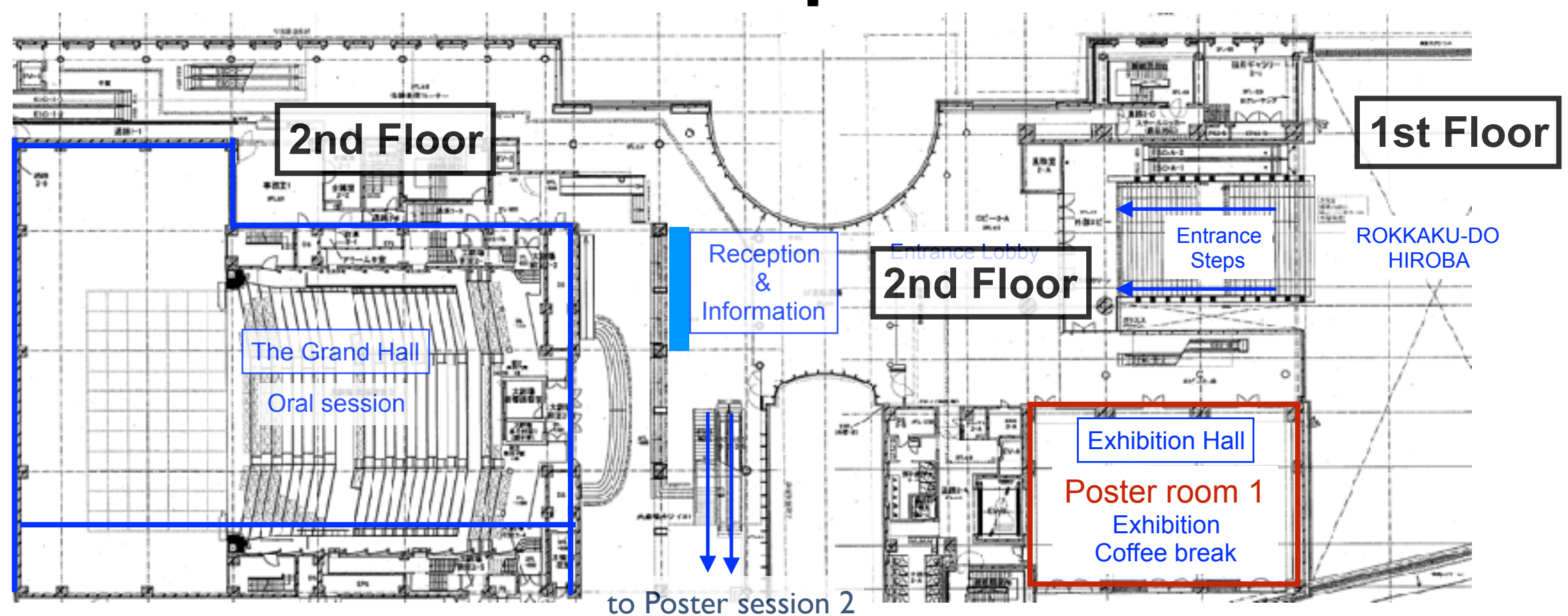

to Nishitetsu
Krume station

Poster room 2

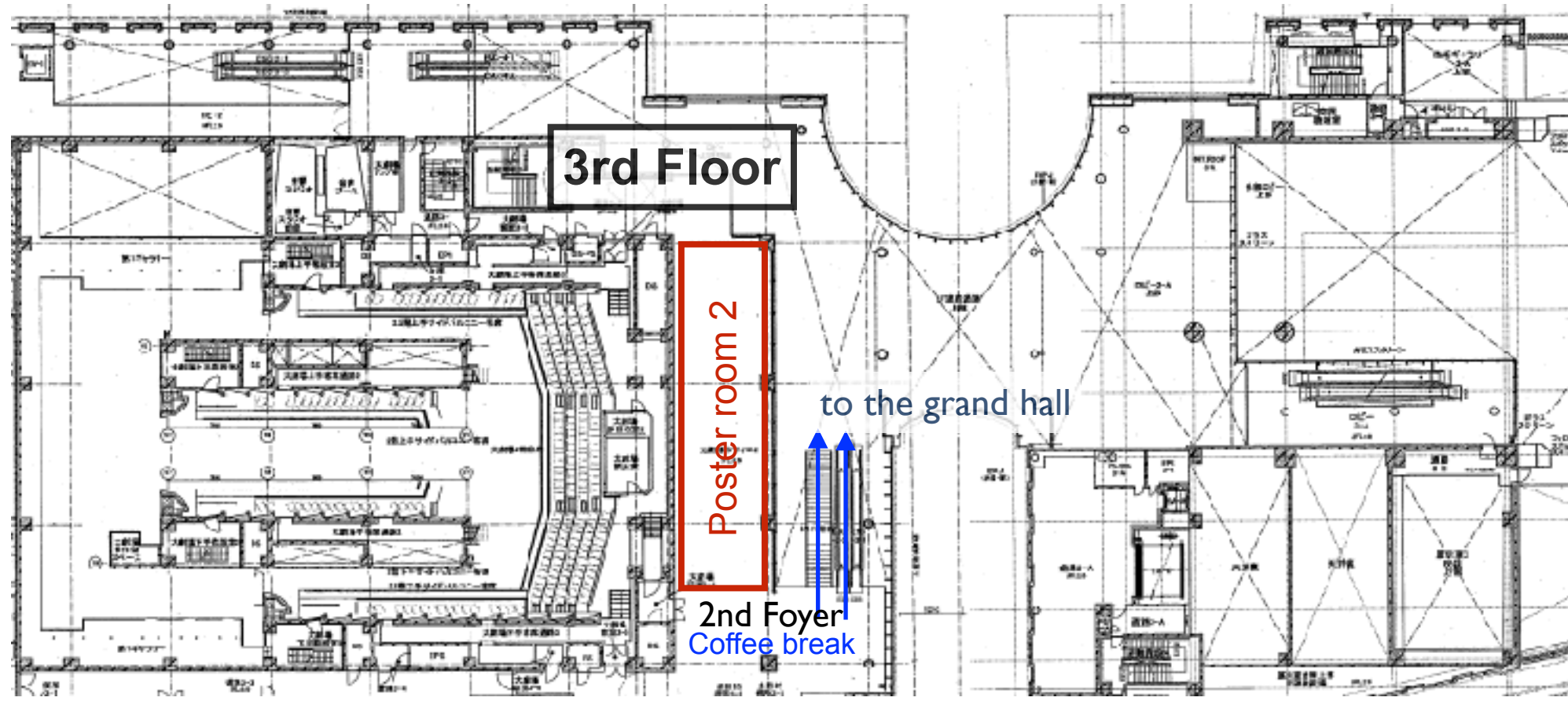

Poster positions

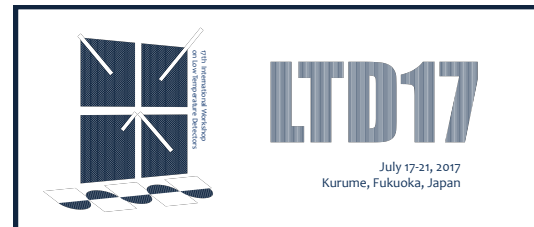

Poster session 2 (2nd foyer; 3F)

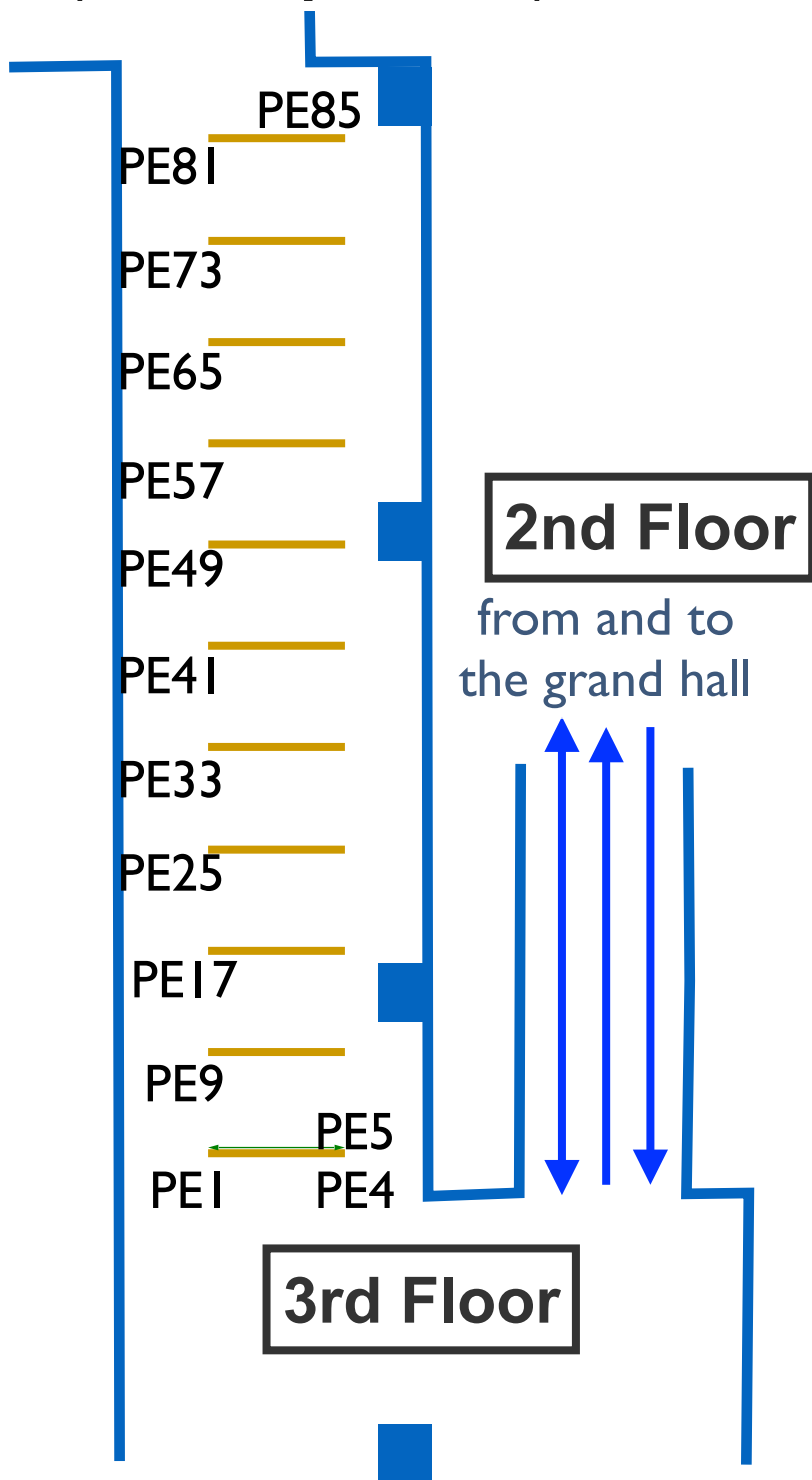

Poster room I (exhibition room; 2F)

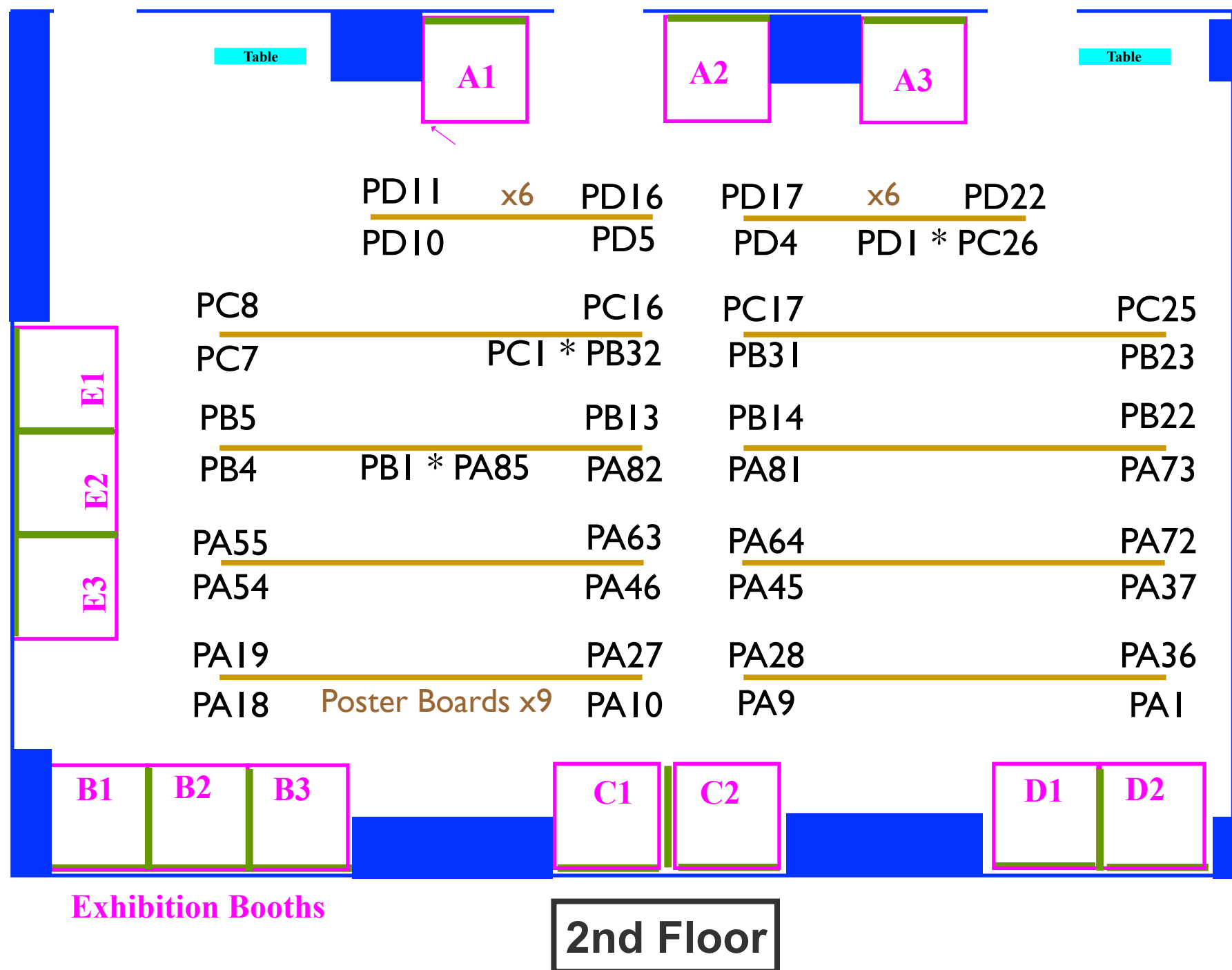

**Please see abstract book for
poster paper index.**

